

CL configuration, ceramic dielectric

Feed through filter range using discoidal ceramics for the capacitive element - type 2R1. This robust multilayer structure provides solutions to RFI problems from 30kHz to 1 GHz. The units are housed in robust, sealed metal containers of thread construction, and offer a range of terminal finishes. Specifically designed for military, industrial, telecoms and medical applications.

- Capacitive value – 1.2uF 80Vdc rated
- Wide choice of performance options
- Excellent temperature stability
- Hermetic construction



Mechanical Specifications

Manufacture: sealed threaded construction
 Connections: wire or tag terminations
 Mounting: thread ¼ inch-28 UNF 2A

Case Variants

Style	Seal	L1 max	L2 max	L3 max	L4 (std)		L4 (long thread)		D2	
					TAG	PIN	TAG	PIN		
1	resin	4.6	4.85	8.25	17	8.9	17.2		1	
2	resin	4.6	7.95	8.25	17	-	-	12	29.3	1
3	hermetic	4.6	4.85	8.5	17	8.9	17.2	-	-	1.5
4	hermetic	4.6	7.95	8.5	17	-	-	12	29.3	1.5
5	hermetic	14.7	4.85	18.8	27	8.9	17.2	-	-	1.5
6	hermetic	14.7	7.95	18.8	27	-	-	12	29.3	1.5

Filter Range - AKCL

(example pt no. - AKCL100412RKT1S)

Code	Max values		Typical Insertion loss (dB)							CCT
	I _{dc} (A)	R _{dc} (Ω)	30 kHz	150 kHz	300 kHz	1 MHz	10 MHz	1 GHz		
100 412RK-1-	15	0.008	15	28	34	44	60	70	1	
100 412RK-3-	15	0.008	15	28	34	44	60	70	1	
100 412RA-5-	0.06	70	44	70	70	70	70	70	1	
101 412RA-5-	0.06	70	44	70	70	70	70	70	2	
100 412RB-5-	0.15	12	24	52	64	70	70	70	1	
101 412RB-5-	0.15	12	24	52	64	70	70	70	2	
100 412RC-5-	0.25	4	18	42	56	70	70	70	1	
101 412RC-5-	0.25	5	18	42	56	70	70	70	2	
100 412RD-5-	0.30	2.3	16	35	44	62	70	70	1	
101 412RD-5-	0.30	2.3	16	35	44	62	70	70	2	
100 412RE-5-	0.45	1.2	15	31	37	55	70	70	1	
101 412RE-5-	0.45	1.2	15	31	37	55	70	70	2	
100 412RJ-5-	10	0.01	15	28	33	44	64	70	1	
101 412RJ-5-	10	0.01	15	28	33	44	64	70	2	

Case finish: T = Tin plated
 S = Silver plated
 G = Gold plated
 Case style available: 2 instead of 1; 4 instead of 3; 6 instead of 5
 Termination: W = Wire
 T = Tag
 P = Headed wire
 I_{dc} (category current) equals 0.6 I_R (rated current) with linear derating from 105°C to +125°C

Electrical Specifications

Rated voltage (V_R): 80 Vdc
 Category voltage (V_C): 50 Vdc
 Rated current (I_R): referred to room temperature = 40°C
 Voltage test (2_s): 2.5 V_R dc
 Climatic category: (55/125/56);
 Temperature range: -55°C to +125°C
 Capacitance value: 1.2uF

Dimensions (mm) and connections

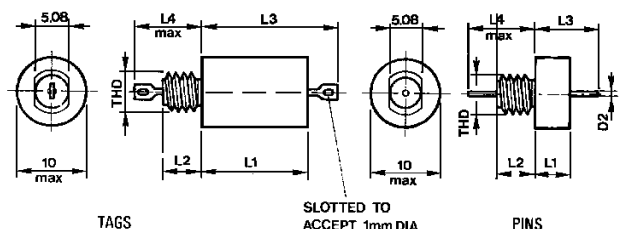

Circuit diagram (CL configuration)

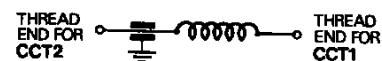

OTHER PRODUCT RANGES AVAILABLE:

Ceramic feed through filters (CL, Pi, 1T, CC, 2P, 2T configurations)
 AK 100-101 series in accordance with BS9121 F0009
 AK 170-171 series in accordance with BS9121 F0011
 Please, contact Arcotronics UK for more detailed information.

Approvals

BS 9121 F0008 meets MIL-F-15733 requirements